

ARNE



PRODUCT INFO

DESIGNER: ANTONIO CITTERIO

TYPOLOGY: SOFAS

COLLECTION: B&B ITALIA

YEAR: 2005

DESCRIPTION

DESIGNED TO CREATE THE SETTING FOR LEISURE ACTIVITIES, ARNE STANDS OUT FOR THE CURVED SHAPE THAT ENVELOPS THE USER. IT IS AN INVITATION TO SOCIALISE AND SHARE MOMENTS TOGETHER, TO CONVERSE AND WATCH TELEVISION SHOWS ON A LARGE SCREEN. IT HAS ALL THE FEATURES OF THE PROTAGONIST DESIGNED TO BE CENTRALLY PLACED IN THE ROOM AND, EVEN PLACED AGAINST A WALL, IT NEVER LOSES ITS IMAGE OF COMFORT AND LIGHTNESS CONVEYED BY THE ALUMINIUM SUPPORTS ON WHICH BOTH SEAT AND BACKREST SEEM TO BE SUSPENDED.

ARNE

TECHNICAL INFORMATION

- **INTERNAL FRAME:**
TUBULAR STEEL AND STEEL PROFILES
- **INTERNAL FRAME UPHOLSTERY:**
BAYFIT® FLEXIBLE COLD SHAPED POLYURETHANE FOAM, POLYESTER FIBRE COVER
- **SEAT CUSHION UPHOLSTERY:**
SHAPED POLYURETHANE, STERILIZED DOWN, POLYESTER FIBRE COVER
- **SUPPORT FRAME:**
BRIGHT BRUSHED DIE-CAST AND EXTRUDED ALUMINIUM
- **COVER:**
FABRIC OR LEATHER

ARNE

TECHNICAL DRAWINGS

A252C

A257CD

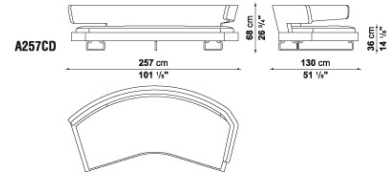
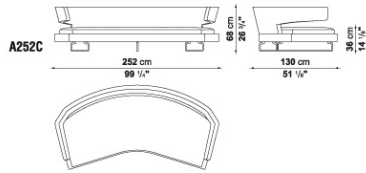

A257CS

A261C

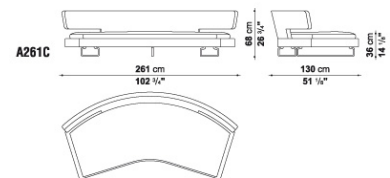
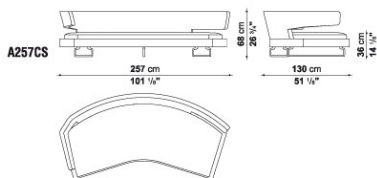

A315CD_1

A315CD_2

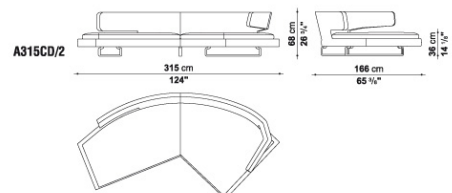
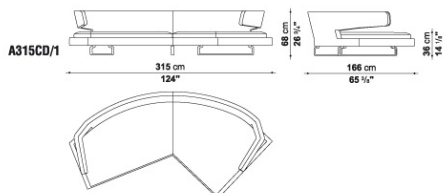

A315CS_1

A315CS_2

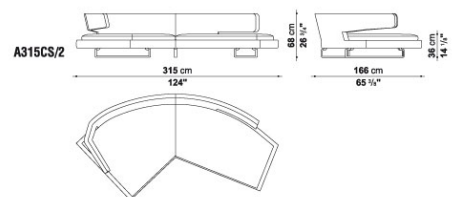
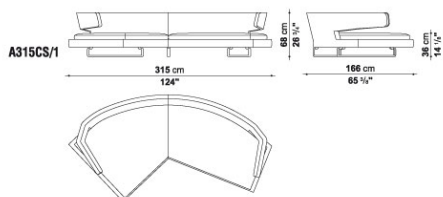

ARNE

TECHNICAL DRAWINGS

A320C_1

A320C_2

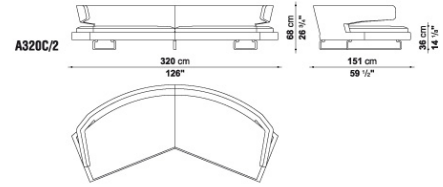
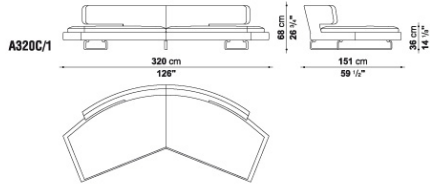

A320CD_3

A320CS_3

